



FIXED LEG TABLE

USER GUIDE

This page was intentionally left blank.

TABLE OF CONTENTS

Parts Diagram	4
Safety Information	5
Assembly Instructions	6-9

STANDARDS & CERTIFICATIONS

Meets 2014 BIFMA standards (glides only).

WARRANTY

Contact your sales representative for warranty information.

PARTS DIAGRAM

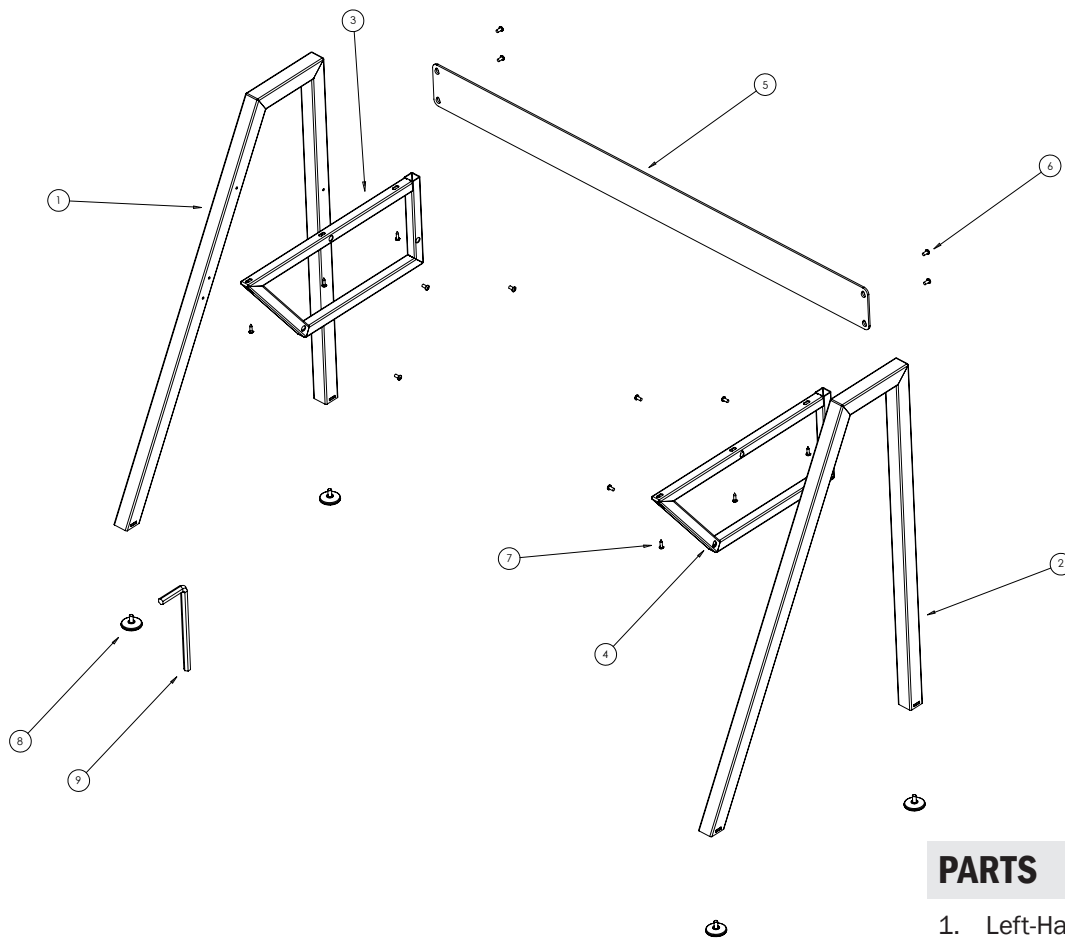

PARTS

Qty/Package

1.	Left-Hand End Leg	1
2.	Right-Hand End Leg	1
3.	Left-Hand Support Brace	1
4.	Right-Hand Support Brace	1
5.	Back Plate	1
6.	M6x1.0 12mm Screws	10
7.	#10-12 0.75in Screws	6
8.	Glides	4
9.	Allen Wrench	1

SAFETY INFORMATION

IMPORTANT SAFETY INSTRUCTIONS *Save these instructions.*

DO NOT OVERLOAD DESK

To prevent table from tipping or collapsing, make sure the desk frame is not overloaded by the weight of tabletop and objects on table. Evenly distribute load; excess loads near edges can reduce stability and cause table to tip over.

- Do not exceed maximum load (including weight of desktop) of 200 lb (91Kg)
- Do not exceed edge load of 25 lb when positioning monitors or mounting accessories
- Do not sit or stand on table

USE CARE WHEN MOVING TABLE

- Remove all objects and mounted accessories from the table before moving
- Clear objects and equipment from table before rolling to reduce the risk of tipping over

ASSEMBLY INSTRUCTIONS

The assembly of the table frame to be made in accordance with this manual.
Changes to the table frame or improper use may affect the safety, function, and life of your product.

1 DETERMINE LEG CONFIGURATION

Use appropriate hole(s) for 24in or 30in support brace.

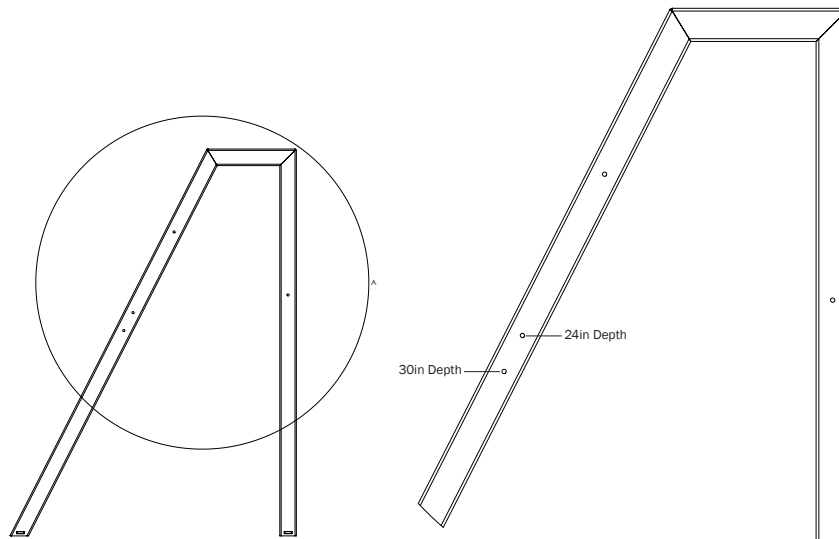

2 INSTALL MOUNTING SCREWS

Thread the M6 screws into the side and back of the end legs about halfway of the screws' length

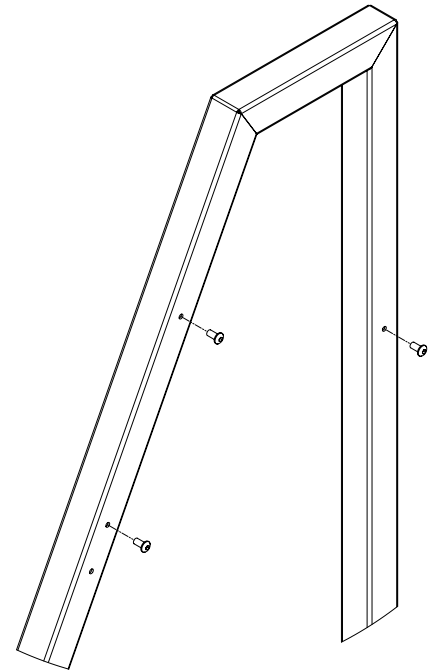
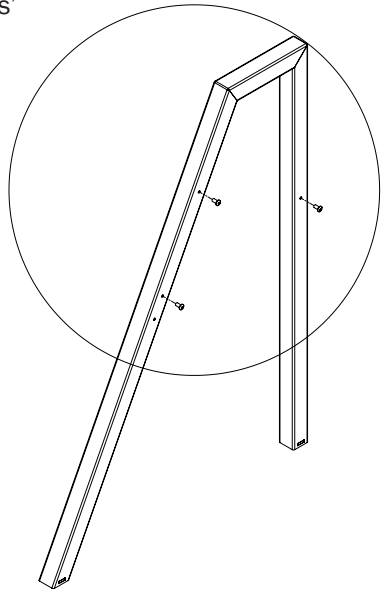

3 INSTALL SUPPORT BRACES

Align the slots on the brace support with the end legs' screws, mount and tighten using the tool provided.

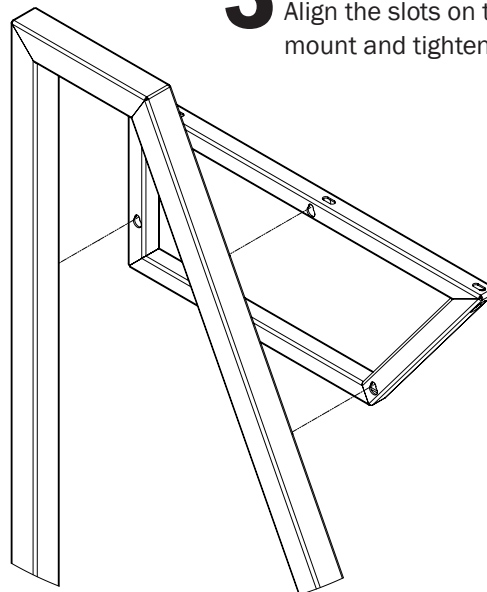
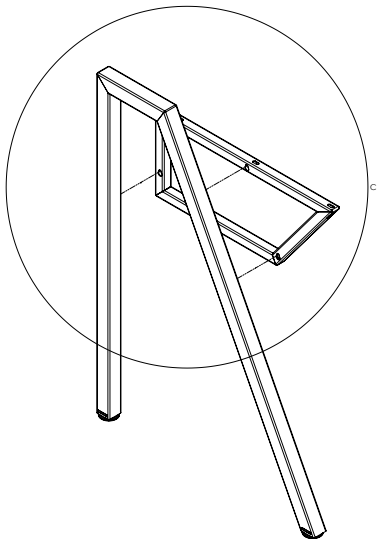

End of life cycle: Once product is disassembled, all steel components can be recycled at your local metal collector. For products with electronic components, see Disassembly Guide.

4 INSTALL LEVELER

Install the glides or casters based on your configuration

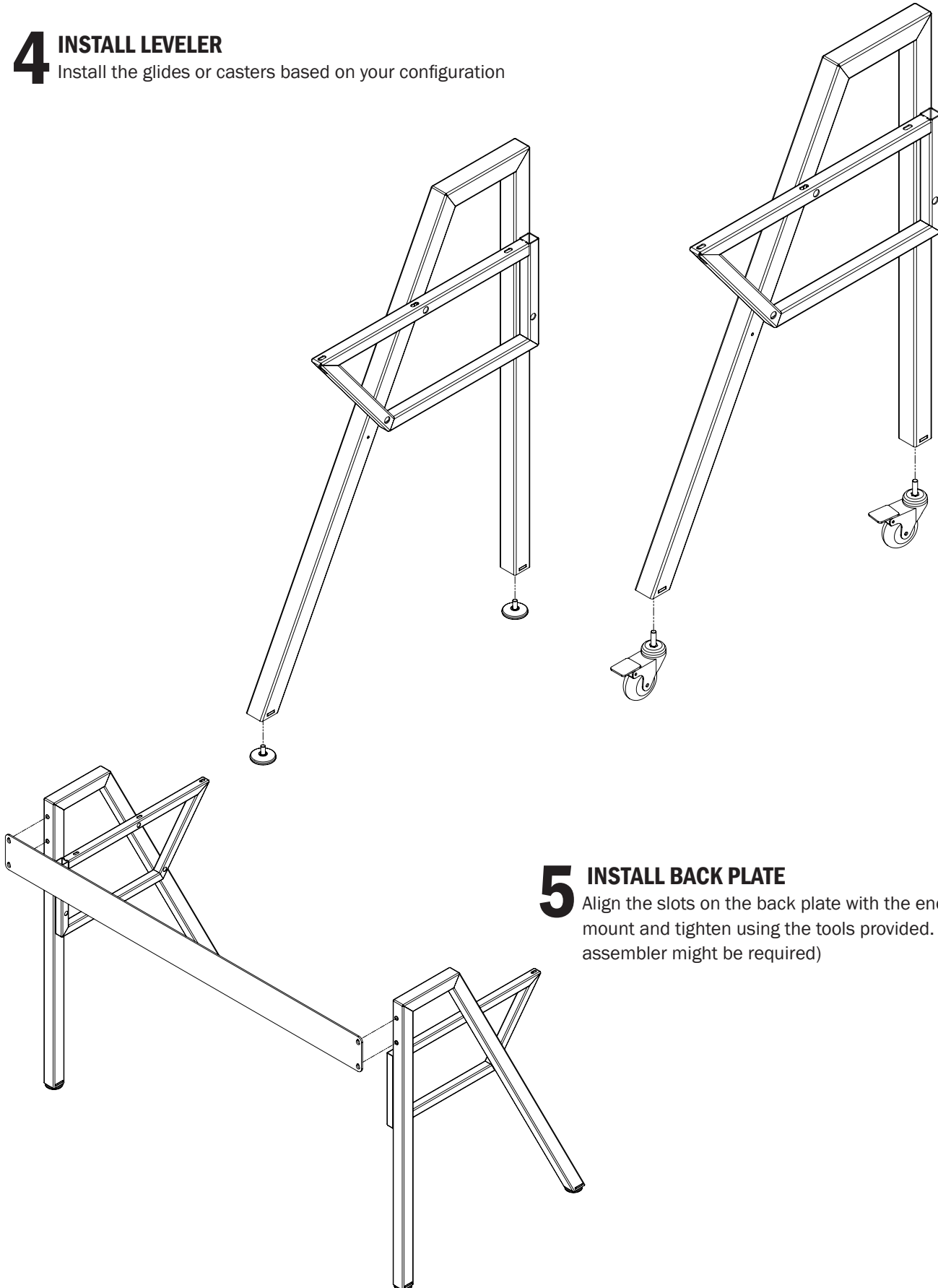

5 INSTALL BACK PLATE

Align the slots on the back plate with the end legs' screws, mount and tighten using the tools provided. (More than one assembler might be required)

6 INSTALL WORK SURFACE

Add the work surface to the finished frame and align the pilot holes on the work surface with the mounting hole on the frame before attaching. Attach using the #10 wood screws provided.

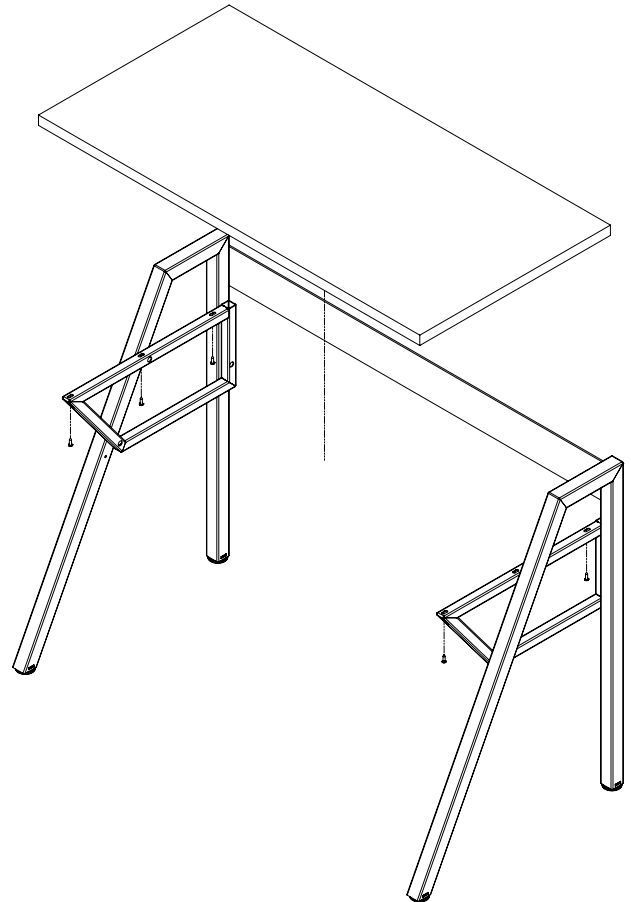

End of life cycle: Once product is disassembled, all steel components can be recycled at your local metal collector. For products with electronic components, see Disassembly Guide.

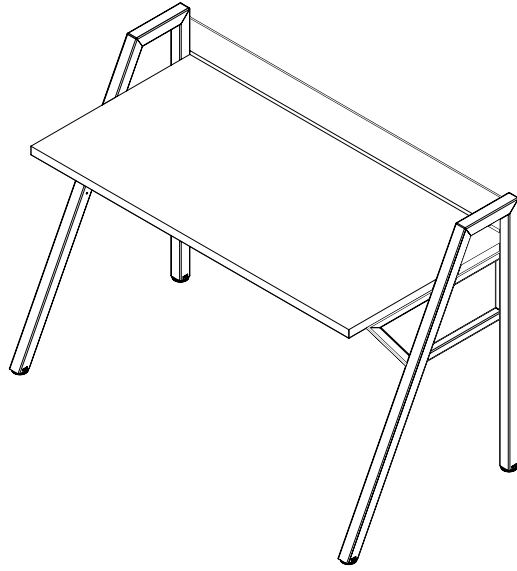

USER GUIDE